



Quick Charge 2.0 Car charger

The Quick Charge 2.0 Car charger will speed up to 75% faster than conventional technology and no need to replace existing charger cable.

Input : 12V~24V / 2.5A

USB Output port :

a. Normal state : 5V/2.1A OUT

b. Quick Charge state : 9V/2A or 12V/2A OUT

Quick Charged LED Indicator :

a. Green LED : Normal 5V OUT

b. Orange LED : Quick Charge 9V or 12V OUT

Charge Speed up 75%

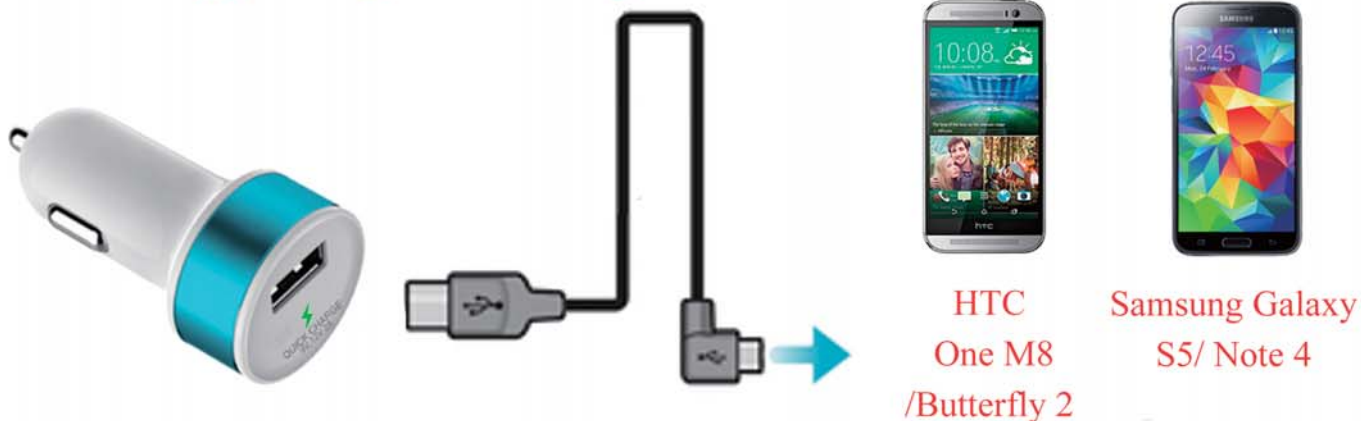

QC2.0 function is built in Qualcomm Snapdragon 800 CPU series, but QC 2.0 not for all of mobiles used Snapdragon 800, they have to depend each of manufacturers design and decision.

There are some mobile models have the QC 2.0 function for your reference as below:

Droid Turbo by Motorola, New Moto X by Motorola, Fujitsu Arrows NX, HTC Butterfly 2, HTC One (M8), HTC Desire Eye, HTC One remix, Nexus 6 from Google, Samsung GALAXY Note 4, Samsung GALAXY Note Edge, Samsung GALAXY S5 (Japan), Sharp Aquos Zeta, Sony Xperia Z2, Sony Xperia Z3, Sony Xperia Z3 Compact, Xiaomi Mi3, Xiaomi Mi4, Sharp Aquos Tab, Sony Xperia Z2, Sony Z3 Tablet Compact, *Use the USB data & sync charger cable only.